

Der 7-16 Steckverbinder hat sich durch seine herausragenden mechanischen und elektrischen Eigenschaften zum weltweit am meisten verwendeten koaxialen Stecksystem für Mobilfunk-Sendeanlagen entwickelt.

Um eine optimale Intermodulationsdämpfung von typ. -165 dBc zu erhalten, sind alle Innen- und Außenleiterteile der SPINNER Standardausführung versilbert. Unterstützend werden ausschließlich nicht-magnetische Werkstoffe verwendet und die Anzahl der HF-Kontaktstellen ist minimiert.

Die Steckverbindung ist besonders geeignet für die Übertragung mittlerer und hoher Leistungen, u. a. im Outdoor-Bereich, bis zu einer Frequenz von 8,3 GHz. Wie bei allen anderen SPINNER Steckverbindern sind auch unsere 7-16 Stecker mit der speziellen SPINNER-Profil Überwurfmutter versehen. Diese ermöglicht in Verbindung mit der Befestigung durch Einrollen ein erhöhtes Prüfdrehmoment von bis zu 55 Nm.

The 7-16 connector has come to be the most frequently used coaxial connection system for mobile communication transmitter systems due to its excellent mechanical and electrical properties.

In order to achieve the optimum intermodulation performance of typically -165 dBc SPINNER applies silver-plating on all inner and outer conductor parts of the standard version. As a supporting measure we use exclusively non-magnetic materials, and we have minimised the number of RF contact points.

The connection is especially suited for transmitting medium or high power, also outdoors, up to a frequency of 8.3 GHz. Like all other SPINNER connectors our 7-16 connectors are also equipped with the special SPINNER profile coupling nut. This nut, which is fastened by flanging, allows a high test torque up to 55 Nm.

*Die 50 Ω Steckverbindung 7-16 ist eine Variante des in den 1960er Jahren entwickelten 6-16 Stecksystems (60 Ω), an dessen Entwicklung und Normung SPINNER maßgeblich beteiligt war. Die Bezeichnung ist abgeleitet von den metrischen Abmessungen des Innen- und Außenleiters.*

*The 50 Ω connector 7-16 is a variant of the connector system 6-16 (60 Ω) developed in the 1960s with SPINNER strongly involved in its development and standardisation. The designation is derived from the metric dimensions of the inner and outer conductor.*



Elektrisch / Electrical	IEC 60169-4	IEC	SPINNER	Bemerkung / Remarks
Wellenwiderstand Characteristic impedance		50 Ω		
Frequenzbereich Frequency range	3.	7.5 GHz	8.3 GHz	
VSWR	3.	≤ 1.22		gerader Steckverbinder bis 6 GHz straight connector up to 6 GHz
Innenleiter-Kontaktwiderstand Center contact resistance	9.4.2	≤ 0.4 mΩ		anfänglich initial
Außenleiter-Kontaktwiderstand Outer contact resistance	9.8.2	≤ 0.02 mΩ		anfänglich initial
Isolationswiderstand Insulation resistance	9.1	≥ 10 GΩ		anfänglich initial
Spannungsfestigkeit in Meereshöhe Proof voltage at sea level	9.1	4 kV		50...60 Hz
Arbeitsspannung in Meereshöhe Working voltage at sea level	3.	2.7 kV		50...60 Hz
Wirksamkeit der Abschirmung Screening effectiveness	9.8.2	≥ 128 dB		

Mechanisch / Mechanical	IEC 60169-4	IEC	SPINNER	Bemerkung / Remarks
Kupplungsdrehmoment Coupling torque	9.5	25 Nm	25...30 Nm	
Prüfdrehmoment Proof torque		35 Nm	55 Nm	
Zugfestigkeit des Kupplungsmechanismus Tensile strength of coupling mechanism			1000 N	
Mechanische Lebensdauer Mechanical lifetime	9.5	500	10000	Betätigungen Operations
Fesselung des Innenleiters Center contact captivation				ja yes

Umwelt / Environmental	IEC 60169-4	IEC	SPINNER	Bemerkung / Remarks
Klimaklasse / Climatic category	4.	55/155/56		
Temperaturbereich / Temperature range	4.	-55...+155 °C		
Schutzgrad / Degree of protection		IP68		gesteckt / mated

Werkstoffe und Oberflächenbehandlung / Materials and Surface Finish	
Federnde Kontaktteile Resilient contact members	hochfeste Cu-Legierung, versilbert high strength copper alloy, silver plated
Isolation Insulation	PTFE/FEP
Innen- und Außenleiterkontaktteile Center and outer conductor parts	Cu-Legierung, versilbert Copper alloy, silver plated
Sonstige Metallteile Other metal parts	Cu-Legierung, glanzvernickelt Copper alloy, bright nickel plated
Dichtungen Gaskets	Silikonkautschuk Silicone rubber

KABELSTECKVERBINDER ■ CABLE CONNECTORS

Kabelstecker – Straight cable plugs



BN 80 76 25

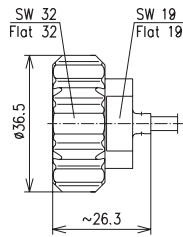

Kabel Typ Cable type	Ausführung Version	Bestell-Nr. Part-No.
RG 402/U	gelötet soldered	BN 80 76 25
RG 401/U Semirigid flexibel 250	gelötet soldered	BN 80 76 21
RG 213/U	geklemmt clamped	BN 19 59 20
RG 214/U RG 393/U	geklemmt clamped	BN 95 18 20



BN 80 76 21

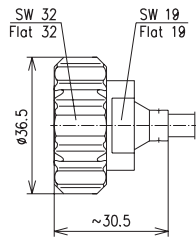

BN 19 59 20

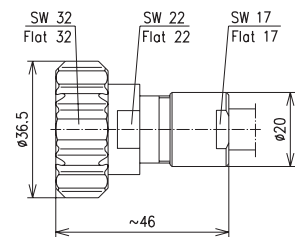

BN 95 18 20

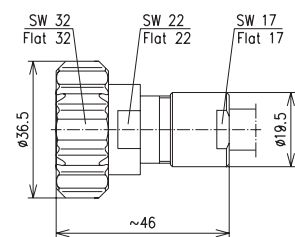

KABELSTECKVERBINDER ■ CABLE CONNECTORS

Kabelstecker – Straight cable plugs



BN 95 18 22

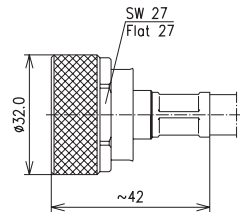

Kabel Typ Cable type	Ausführung Version	Bestell-Nr. Part-No.
RG 214/U	gecrimpt	BN 95 18 22
RG 393/U	crimped	
RG 217/U	geklemmt	BN 59 06 00
RG 218/U	clamped	
RG 218/U	geklemmt	BN 93 26 00
RG 218/U	clamped	
SCF14-50	CAF® Schrumpfschlauch CAF® heat shrink sleeve	BN 74 14 60



BN 59 06 00

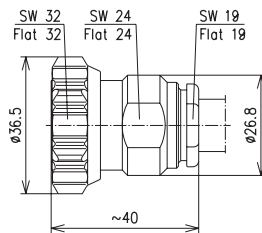

BN 93 26 00

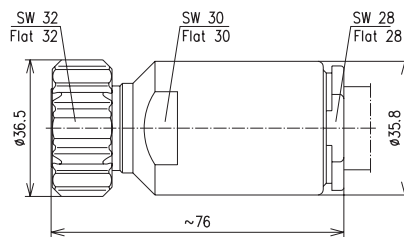

BN 74 14 60

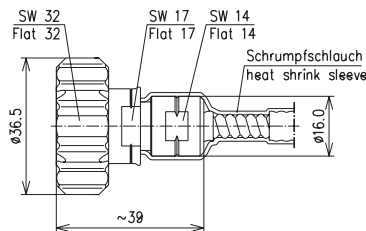

KABELSTECKVERBINDER ■ CABLE CONNECTORS

Kabelstecker – Straight cable plugs



BN 84 73 39

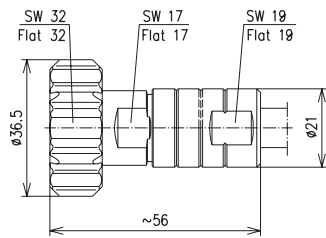

Kabel Typ Cable type	Ausführung Version	Bestell-Nr. Part-No.
SCF38-50	CAF® Profildichtung CAF® profile gasket	BN 84 73 39
SCF/UCF12-50	CAF® Profildichtung CAF® profile gasket	BN 84 73 59
HCA38-50	CAF® Plast 2000®	BN 97 06 28
HCA58-50	CAF® Plast 2000®	BN 92 55 25



BN 84 73 59

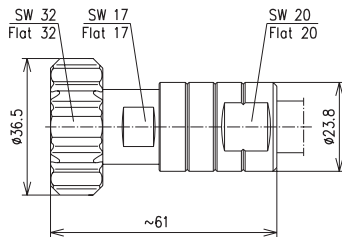

BN 97 06 28

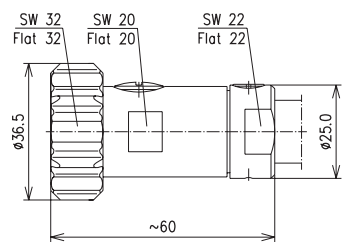

BN 92 55 25

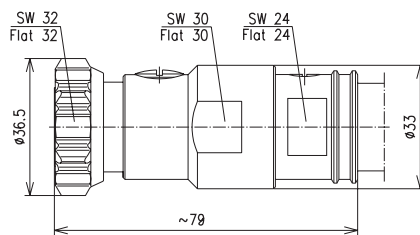

KABELSTECKVERBINDER ■ CABLE CONNECTORS

Kabelstecker – Straight cable plugs



BN 49 18 18

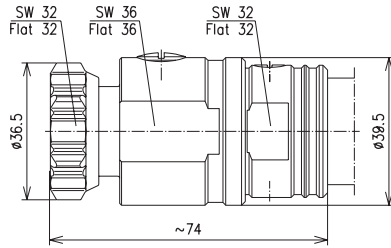

Kabel Typ Cable type	Ausführung Version	Bestell-Nr. Part-No.
HCA78-50	CAF® Plast 2000®	BN 49 18 18
HCA158-50	Premium Plast 2000®	BN 69 06 10
LCF14-50	CAF® O-Ring	BN 74 14 45
LCF38-50	CAF® O-Ring	BN 84 73 69



BN 69 06 10

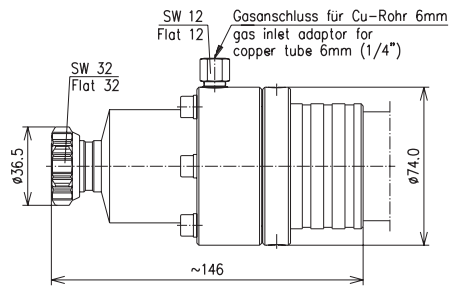

BN 74 14 45

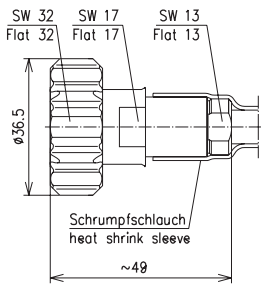

BN 84 73 69

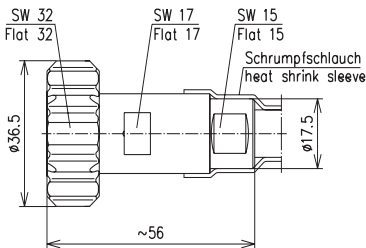

KABELSTECKVERBINDER ■ CABLE CONNECTORS

Kabelstecker – Straight cable plugs



BN 84 73 68

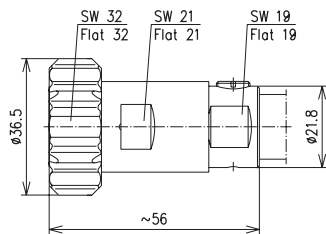

Kabel Typ Cable type	Ausführung Version	Bestell-Nr. Part-No.
LCF12-50	CAF® Plast 2000®	BN 84 73 68
LCF12-50	CAF® O-Ring	BN 84 73 89
LCF/UCF78-50	CAF® Plast 2000®	BN 84 48 40
LCF/UCF78-50	CAF® O-Ring	BN 84 48 41



BN 84 73 89

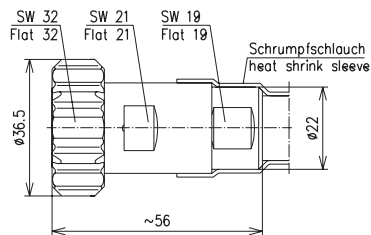

BN 84 48 40

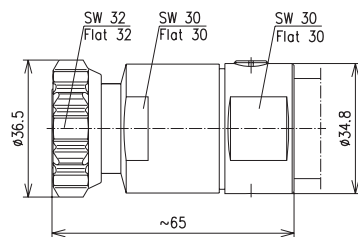

BN 84 48 41

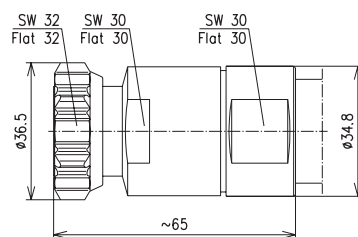

KABELSTECKVERBINDER ■ CABLE CONNECTORS

Kabelstecker – Straight cable plugs



BN 85 43 11

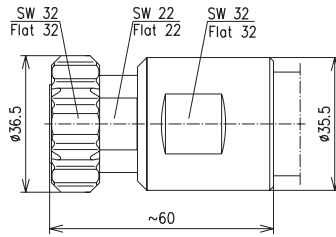

Kabel Typ Cable type	Ausführung Version	Bestell-Nr. Part-No.
LCF/UCF78-50	TOPSPIN® O-Ring	BN 85 43 11
UCF/LCFS114-50	CAF® Plast 2000®	BN 84 48 42
UCF/LCFS114-50	CAF® O-Ring	BN 84 48 43
LCF158-50	CAF® Plast 2000®	BN 84 48 44



BN 84 48 42

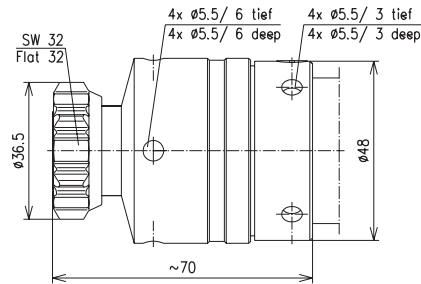

BN 84 48 43

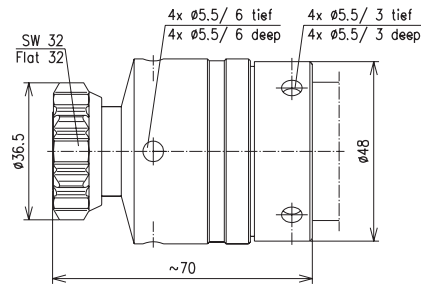

BN 84 48 44

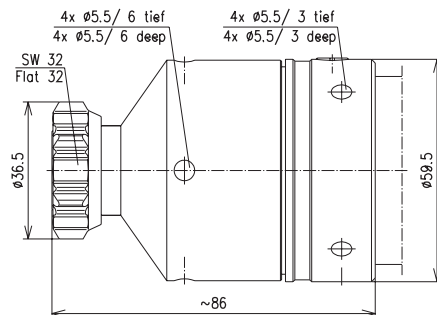

KABELSTECKVERBINDER ■ CABLE CONNECTORS

Kabelstecker – Straight cable plugs



BN 84 48 45

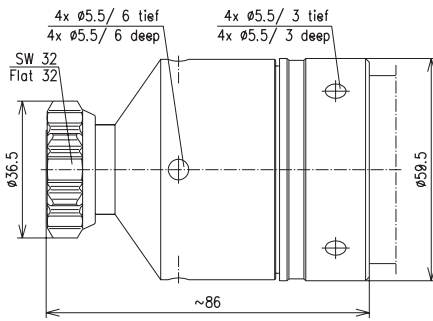

Kabel Typ Cable type	Ausführung Version	Bestell-Nr. Part-No.
LCF158-50	CAF® O-Ring	BN 84 48 45
LCF214-50	CAF® O-Ring	BN 84 48 63
LCF214-50	CAF® Plast 2000®	BN 84 48 73



BN 84 48 63

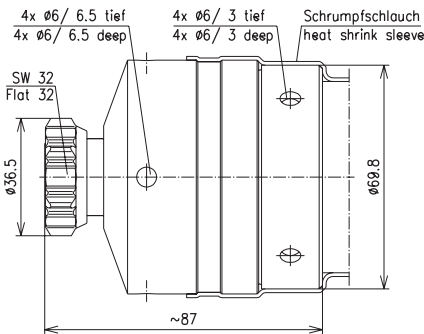

BN 84 48 73

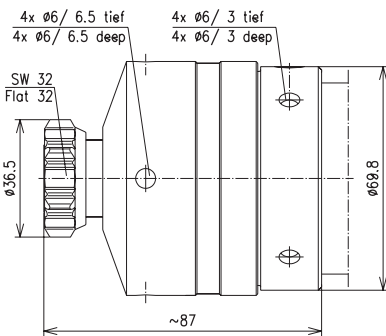

7-16

KABELSTECKVERBINDER ■ CABLE CONNECTORS

Kabelstecker – Straight cable plugs



BN 55 71 12

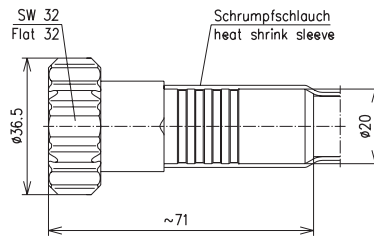

BN 52 71 93

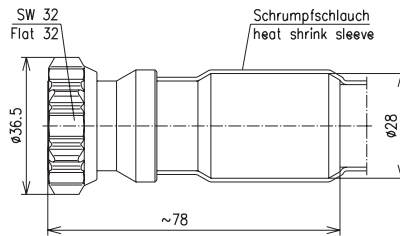

BN 55 71 52

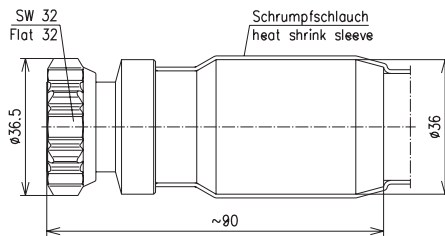

BN 55 71 62

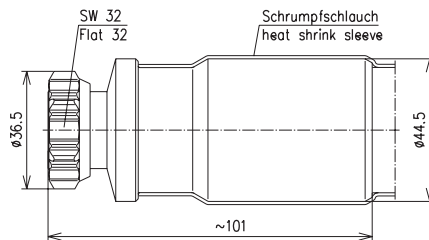

BN 55 71 72

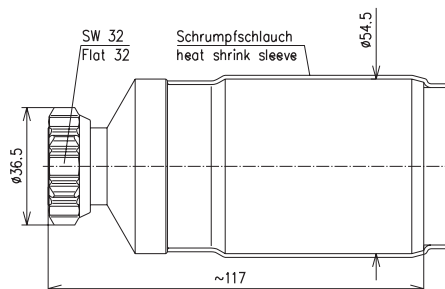

Kabel Typ Cable type	Ausführung Version	Bestell-Nr. Part-No.
RADIAFLEX® 12-50	Schrumpfschlauch Heat shrink sleeve	BN 55 71 12
RADIAFLEX® 58-50	Schrumpfschlauch Heat shrink sleeve	BN 52 71 93
RADIAFLEX® 78-50	Schrumpfschlauch Heat shrink sleeve	BN 55 71 52
RADIAFLEX® 114-50	Schrumpfschlauch Heat shrink sleeve	BN 55 71 62
RADIAFLEX® 158-50	Schrumpfschlauch Heat shrink sleeve	BN 55 71 72

KABELSTECKVERBINDER ■ CABLE CONNECTORS

Kabelwinkelstecker – Right angle cable plugs



BN 94 07 80

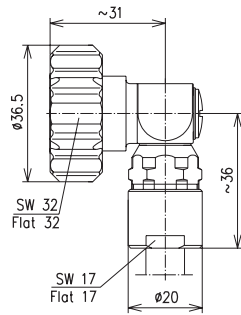

Kabel Typ Cable type	Ausführung Version	Bestell-Nr. Part-No.
RG 213/U	geklemmt clamped	BN 94 07 80
RG 214/U RG 393/U	geklemmt clamped	BN 80 76 80
SCF38-50	CAF® Profildichtung CAF® profile gasket	BN 84 73 73
SCF/UCF12-50	CAF® Profildichtung CAF® profile gasket	BN 84 73 57



BN 80 76 80

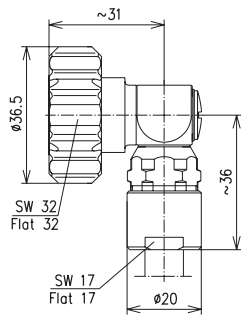

BN 84 73 73

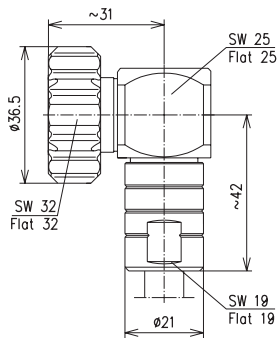

BN 84 73 57

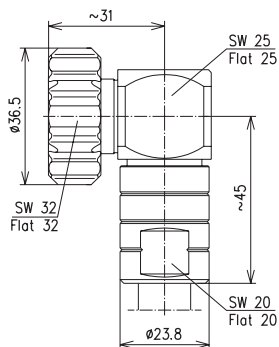

KABELSTECKVERBINDER ■ CABLE CONNECTORS

Kabelwinkelstecker – Right angle cable plugs



BN 84 73 56

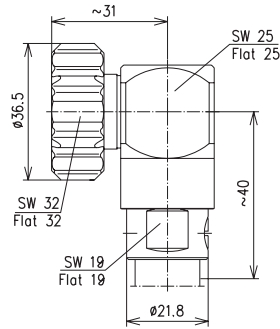

BN 84 73 91

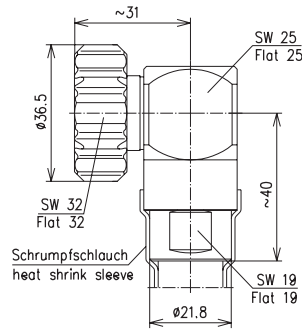

BN 84 48 50

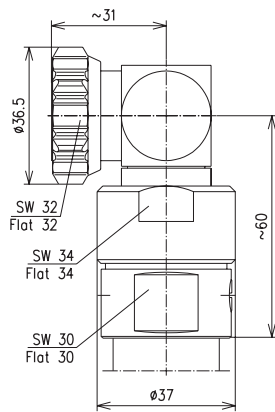

BN 84 48 51

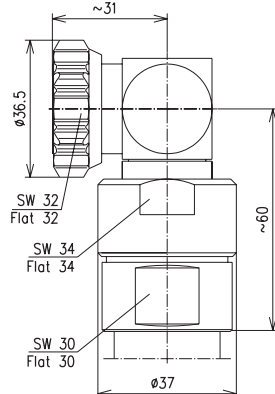

Kabel Typ Cable type	Ausführung Version	Bestell-Nr. Part-No.
LCF12-50	CAF® Plast 2000®	BN 84 73 56
LCF12-50	CAF® O-Ring	BN 84 73 91
LCF/UCF78-50	CAF® Plast 2000®	BN 84 48 50
LCF/UCF78-50	CAF® O-Ring	BN 84 48 51

KABELSTECKVERBINDER ■ CABLE CONNECTORS

Kabelkuppler – Straight cable sockets



BN 29 81 20

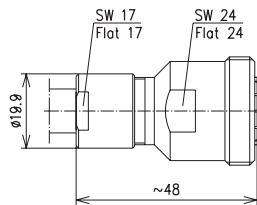

Kabel Typ Cable type	Ausführung Version	Bestell-Nr. Part-No.
RG 213/U	geklemmt clamped	BN 29 81 20
RG 214/U	geklemmt clamped	BN 95 19 20
RG 393/U	geklemmt clamped	BN 95 19 20
RG 214/U	gecrimpt crimped	BN 95 19 22
RG 393/U	gecrimpt crimped	BN 95 19 22
SCF14-50	Schrumpfschlauch Heat shrink sleeve	BN 65 99 60



BN 95 19 20

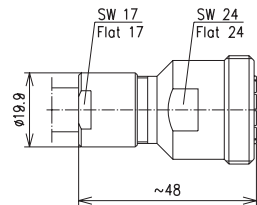

BN 95 19 22

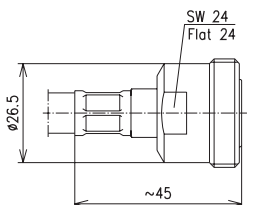

BN 65 99 60

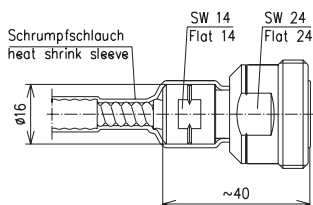

7-16

KABELSTECKVERBINDER ■ CABLE CONNECTORS

Kabelkuppler – Straight cable sockets



BN 71 03 39

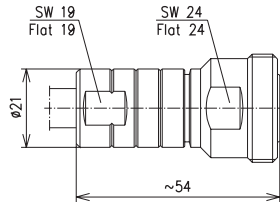

BN 71 03 59

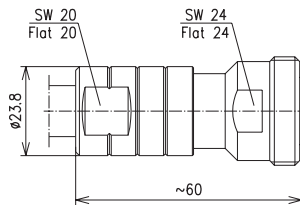

BN 97 07 28

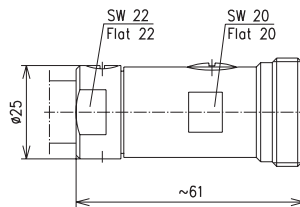

BN 49 90 18

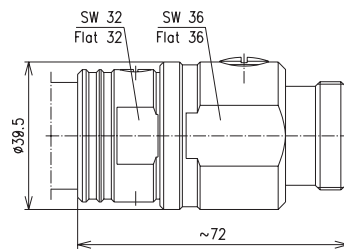

BN 69 07 10

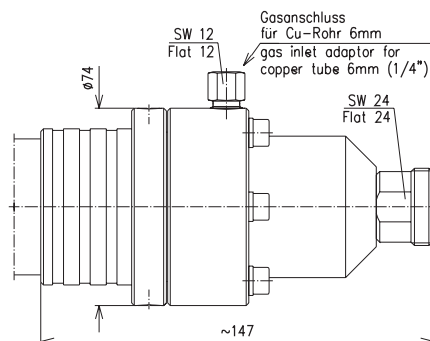

Kabel Typ Cable type	Ausführung Version	Bestell-Nr. Part-No.
SCF38-50	CAF® Profildichtung CAF® profile gasket	BN 71 03 39
SCF/UCF12-50	CAF® Profildichtung CAF® profile gasket	BN 71 03 59
HCA38-50	CAF® Plast 2000®	BN 97 07 28
HCA78-50	CAF® Plast 2000®	BN 49 90 18
HCA158-50	Premium Plast 2000®	BN 69 07 10

KABELSTECKVERBINDER ■ CABLE CONNECTORS

Kabelkuppler – Straight cable sockets



BN 71 03 68

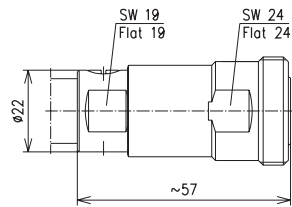

Kabel Typ Cable type	Ausführung Version	Bestell-Nr. Part-No.
LCF12-50	CAF® Plast 2000®	BN 71 03 68
LCF12-50	CAF® O-Ring	BN 71 03 89
LCF/UCF78-50	CAF® Plast 2000®	BN 65 56 40
LCF/UCF78-50	CAF® O-Ring	BN 65 56 41



BN 71 03 89

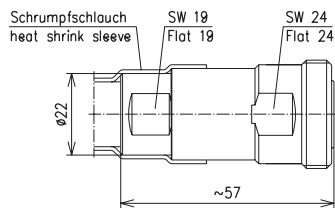

BN 65 56 40

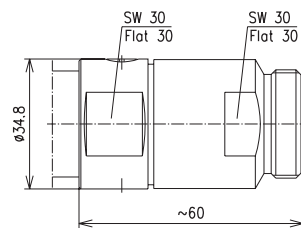

BN 65 56 41

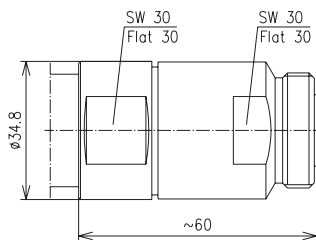

KABELSTECKVERBINDER ■ CABLE CONNECTORS

Kabelkuppler – Straight cable sockets



BN 65 43 11

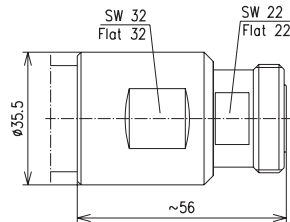

Kabel Typ Cable type	Ausführung Version	Bestell-Nr. Part-No.
LCF/UCF78-50	TOPSPIN® O-Ring	BN 65 43 11
UCF/LCFS114-50	CAF® Plast 2000®	BN 65 56 42
UCF/LCFS114-50	CAF® O-Ring	BN 65 56 43
LCF158-50	CAF® Plast 2000®	BN 65 56 44



BN 65 56 42

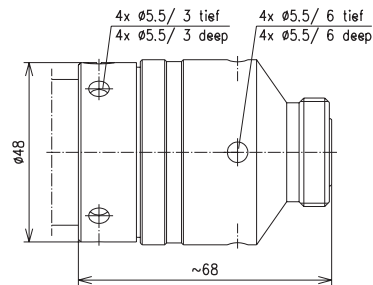

BN 65 56 43

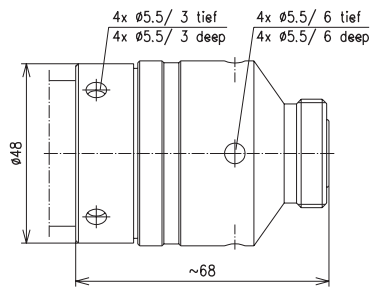

BN 65 56 44

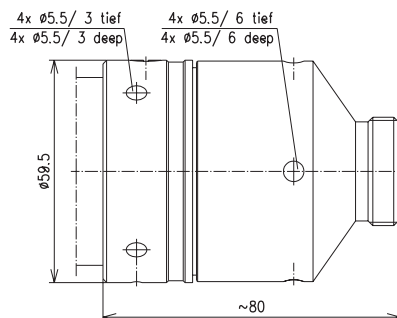

KABELSTECKVERBINDER ■ CABLE CONNECTORS

Kabelkuppler – Straight cable sockets



BN 65 56 45

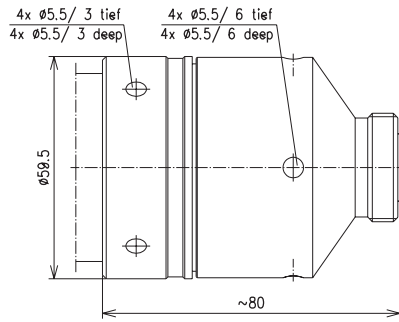

Kabel Typ Cable type	Ausführung Version	Bestell-Nr. Part-No.
LCF158-50	CAF® O-Ring	BN 65 56 45
LCF214-50	CAF® Plast 2000®	BN 65 56 73
LCF214-50	CAF® O-Ring	BN 65 56 63
RADIAFLEX® 12-50	Schrumpfschlauch Heat shrink sleeve	BN 55 71 13



BN 65 56 73

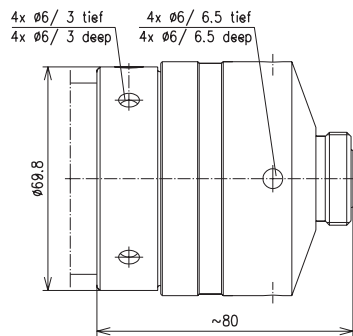

BN 65 56 63

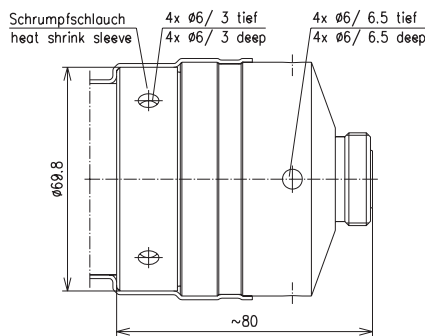

BN 55 71 13

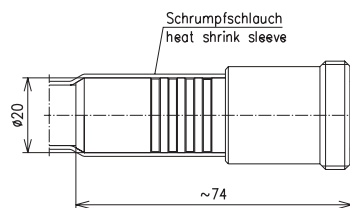

KABELSTECKVERBINDER ■ CABLE CONNECTORS

Kabelkuppler – Straight cable sockets



BN 52 71 94

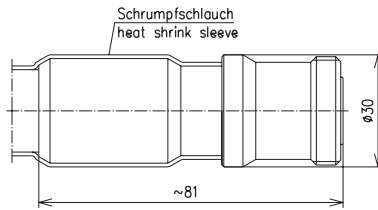

Kabel Typ Cable type	Ausführung Version	Bestell-Nr. Part-No.
RADIAFLEX® 58-50	Schrumpfschlauch Heat shrink sleeve	BN 52 71 94
RADIAFLEX® 78-50	Schrumpfschlauch Heat shrink sleeve	BN 55 71 53
RADIAFLEX® 114-50	Schrumpfschlauch Heat shrink sleeve	BN 55 71 63
RADIAFLEX® 158-50	Schrumpfschlauch Heat shrink sleeve	BN 55 71 73



BN 55 71 53

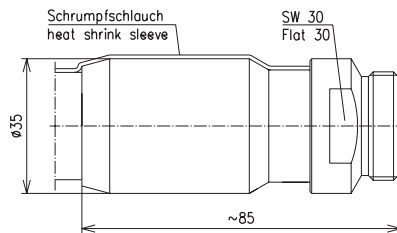

BN 55 71 63

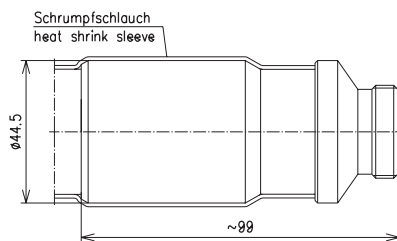

BN 55 71 73

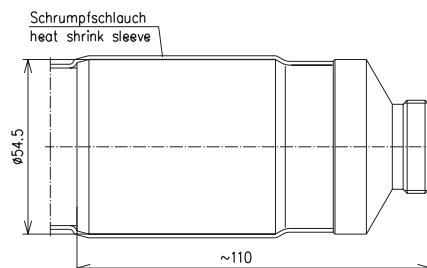

KABELSTECKVERBINDER ■ CABLE CONNECTORS

Gehäusekuppler für Einlochbefestigung – Fixed socket for single hole mounting



BN 80 77 88

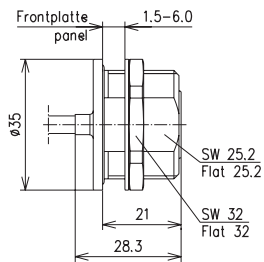

Kabel Typ Cable type	Ausführung Version	Bestell-Nr. Part-No.
RG 402/U Semirigid flexibel 141	gelötet soldered	BN 80 77 88



BN 80 77 33

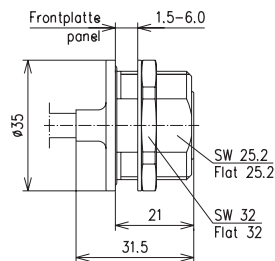

Kabel Typ Cable type	Ausführung Version	Bestell-Nr. Part-No.
RG 401/U	gelötet soldered	BN 80 77 33

Gehäusekuppler mit Viereckflansch – Fixed socket with four hole mounting flange



BN 80 77 50

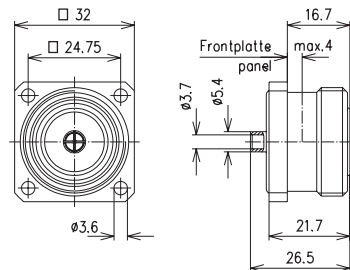

Kabel Typ Cable type	Ausführung Version	Bestell-Nr. Part-No.
RG 402/U Semirigid flexibel 141	gelötet soldered	BN 80 77 50

Abdichtung zum Gehäuse mit O-Ring,  
Innenleiter verdrehungsgesichert  
Sealing to the panel with O-Ring,  
captivated inner conductor



BN 80 77 06

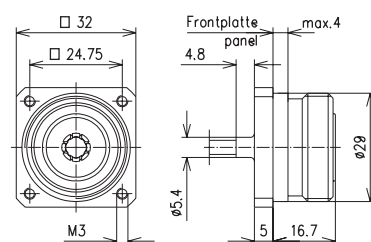

Kabel Typ Cable type	Ausführung Version	Bestell-Nr. Part-No.
RG 402/U Semirigid flexibel 141	gelötet soldered	BN 80 77 06

**KABELSTECKVERBINDER ■ CABLE CONNECTORS**
**Gehäusekuppler mit Viereckflansch – Fixed socket with four hole mounting flange**

BN 80 77 60

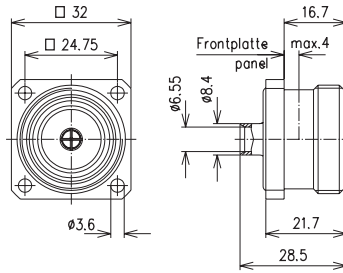

Kabel Typ Cable type	Ausführung Version	Bestell-Nr. Part-No.
RG 401/U	gelötet soldered	BN 80 77 60

Abdichtung zum Gehäuse mit O-Ring,  
Innenleiter verdrehungsgesichert  
Sealing to the panel with O-Ring,  
captivated inner conductor



BN 80 77 86

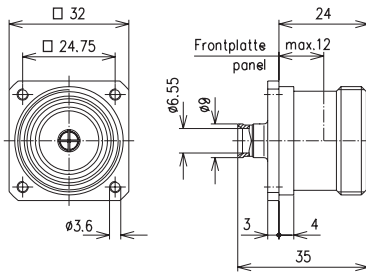

Kabel Typ Cable type	Ausführung Version	Bestell-Nr. Part-No.
RG401/U Semirigid flexibel 250	gelötet soldered	BN 80 77 86



BN 80 77 19

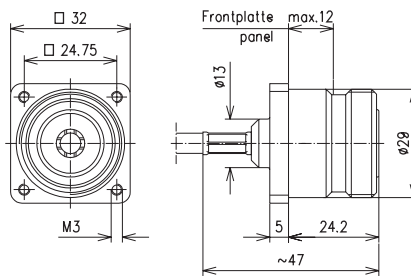

Kabel Typ Cable type	Ausführung Version	Bestell-Nr. Part-No.
RG 223/U	gecrimpt	BN 80 77 19
RG 400/U	crimped	



BN 80 77 18

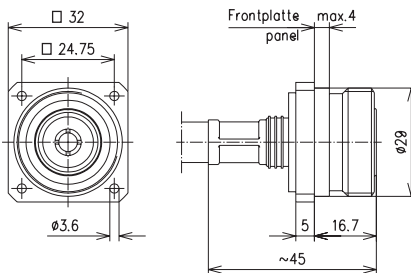

Kabel Typ Cable type	Ausführung Version	Bestell-Nr. Part-No.
RG 393/U	gecrimpt	BN 80 77 18
RG 214/U	crimped	

KABELSTECKVERBINDER ■ CABLE CONNECTORS

Gehäusekuppler mit Viereckflansch – Fixed socket with four hole mounting flange



BN 93 25 00

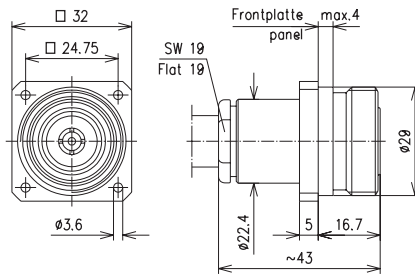

Kabel Typ Cable type	Ausführung Version	Bestell-Nr. Part-No.
RG 217/U	geklemmt clamped	BN 93 25 00

Steckerkopf – Connector head



BN 45 09 95

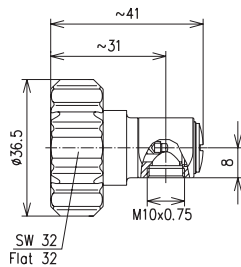

Bestell-Nr. Part-No.	BN 45 09 95
	Kabelabfangungen siehe Seite 77 Cable entries see page 77

GEHÄUSESTECKVERBINDER ■ FIXED CONNECTORS



BN 95 47 16

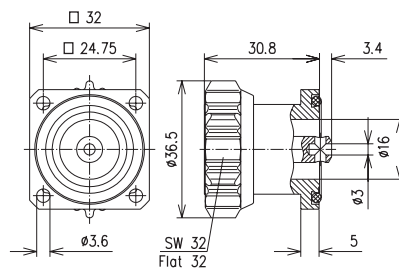

**BN 95 47 16**

Gehäusestecker mit Viereckflansch  
Abdichtung zum Gehäuse mit O-Ring, Innenleiter mit Lötanschluss  
Fixed plug with four hole mounting flange, sealing to the panel with O-Ring, inner conductor with soldering connection



BN 95 47 65

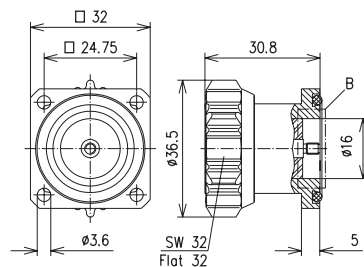

**BN 95 47 65**

Gehäusestecker mit Viereckflansch  
Abdichtung zum Gehäuse mit O-Ring, Innenleiter mit Außengewinde M3  
Fixed plug with four hole mounting flange, sealing to the panel with O-Ring, inner conductor with M3 male thread

**GEHÄUSESTECKVERBINDER ■ FIXED CONNECTORS**

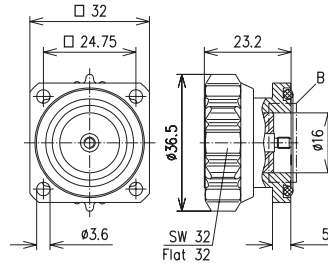
**BN 95 48 38**

**BN 95 48 38**

Gehäusestecker mit Viereckflansch  
Abdichtung zum Gehäuse mit O-Ring,  
Innenleiter verdrehungsgesichert mit  
Außengewinde M3

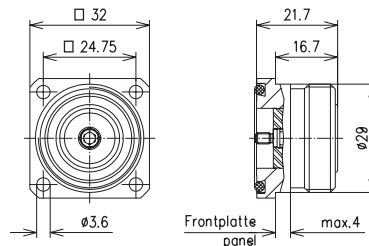
Fixed plug with four hole mounting flange,  
sealing to the panel with O-Ring, captivated  
inner conductor with M3 male thread

**BN 95 46 84**

**BN 95 46 84**

Gehäusekuppler mit Viereckflansch  
Abdichtung zum Gehäuse mit O-Ring,  
Innenleiter verdrehungsgesichert  
mit Außengewinde M3

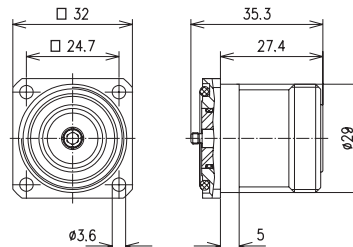
Fixed socket with four hole mounting flange,  
sealing to the panel with O-Ring, captivated  
inner conductor with M3 male thread

**BN 95 46 57**

**BN 95 46 57**

Gehäusekuppler mit Viereckflansch,  
längs- und querdicht,  
Abdichtung zum Gehäuse mit O-Ring,  
Innenleiter mit Außengewinde M3

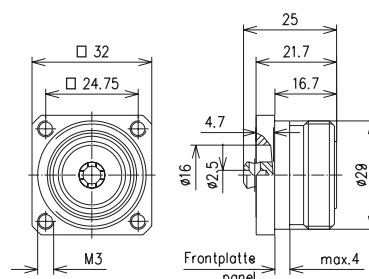
Fixed socket with four hole mounting flange,  
mating face and barrier sealed, sealing to  
the panel with O-Ring, inner conductor  
with M3 male thread

**BN 95 45 18**

**BN 95 45 18**

Gehäusekuppler mit Viereckflansch  
mit Innenleiter-Lötanschluss (Innenleiter  
verdrehungsgesichert)

Fixed socket with four hole mounting flange,  
with inner conductor soldering connection  
(captivated inner conductor)

GEHÄUSESTECKVERBINDER ■ FIXED CONNECTORS



BN 95 45 10

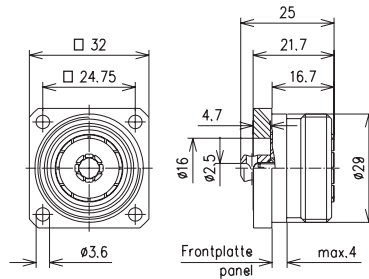

**BN 95 45 10**

Gehäusekuppler mit Viereckflansch, mit Innenleiter-Lötanschluss (Außenleiterkontaktbuchse geschlitzt)

Fixed socket with four hole mounting flange, with inner conductor soldering connection (with slotted outer conductor)

ZWISCHENSTECKVERBINDER ■ WITHIN-TYPE ADAPTORS



BN 39 33 60

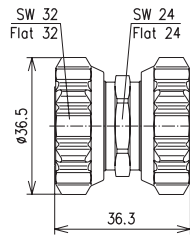

**BN 39 33 60**

Zwischenstecker  
Adaptor, plug-plug



BN 94 47 02

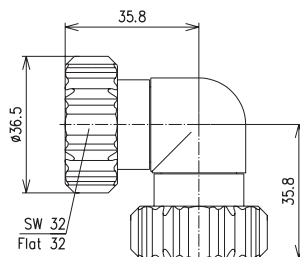

**BN 94 47 02**

Winkelzwischenstecker  
Right angle adaptor, plug-plug



BN 19 64 00

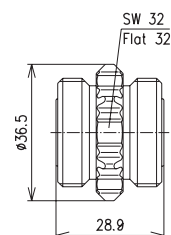

**BN 19 64 00**

Kupplung  
Adaptor, socket-socket

ZWISCHENSTECKVERBINDER ■ WITHIN-TYPE ADAPTORS



BN 92 04 00

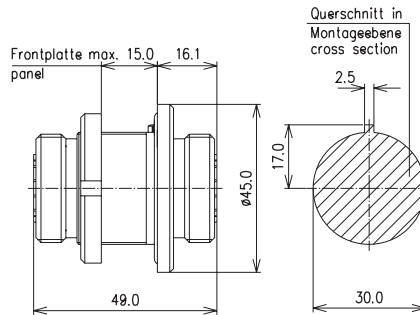

**BN 92 04 00**

Durchführungskupplung für Einlochmontage (einbau- und längsdicht)  
Fixed adaptor, socket-socket for single hole mounting (panel and barrier sealed)



BN 80 84 00

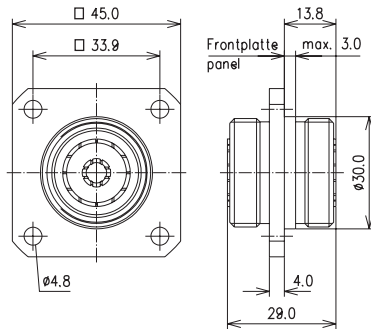

**BN 80 84 00**

Durchführungskupplung mit Viereckflansch  
Fixed adaptor, socket-socket with four hole mounting flange



BN 49 41 10

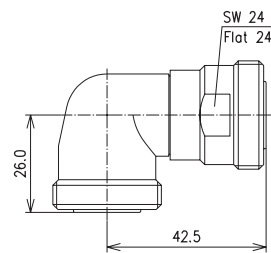

**BN 49 41 10**

Winkelkupplung  
Right angle adaptor, socket-socket



BN 80 86 00

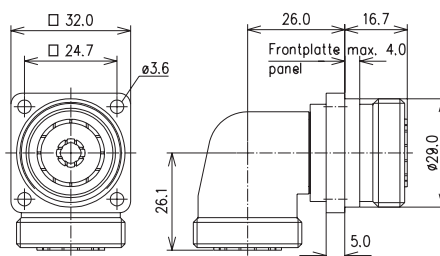

**BN 80 86 00**

Winkeldurchführungskupplung mit Viereckflansch  
Right angle adaptor, socket-socket with four hole mounting flange

ZWISCHENSTECKVERBINDER ■ WITHIN-TYPE ADAPTORS



BN 80 87 00

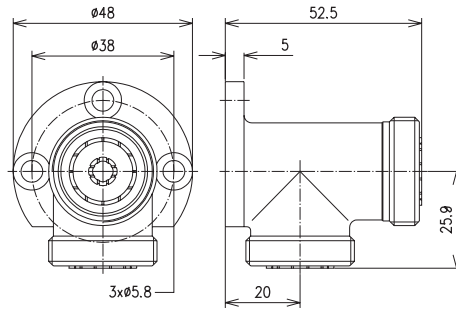

**BN 80 87 00**

Aufbau Winkelkupplung  
Right angle adaptor, socket-socket  
with assembly flange



BN 75 64 04

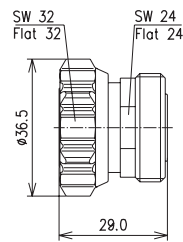

**BN 75 64 04**

Steckerkupplung  
(Schutz für Messanschluss)  
Adaptor, plug-socket  
(port saver)



BN 29 64 00

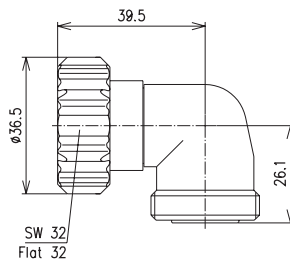

**BN 29 64 00**

Winkelsteckerkupplung  
Right angle adaptor, plug-socket



BN 29 64 01

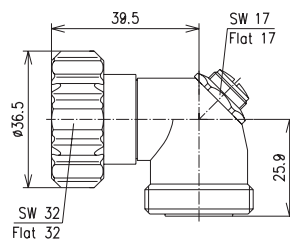

**BN 29 64 01**

Winkelsteckerkupplung  
mit Abgleichschraube  
Right angle adaptor, plug-socket  
with tuning screw

ZWISCHENSTECKVERBINDER ■ WITHIN-TYPE ADAPTORS



BN 81 81 00

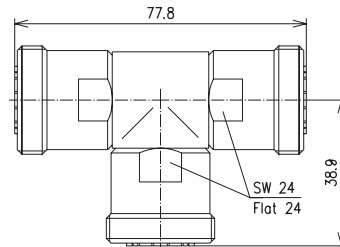

**BN 81 81 00**  
T-Verzweigung,  
Kuppler-Kuppler-Kuppler  
T-adaptor,  
socket-socket-socket



BN 80 64 00

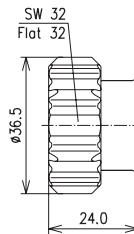

**BN 80 64 00**  
Kurzschluss, Stecker  
Short circuit, plug



BN 80 65 00

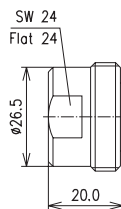

**BN 80 65 00**  
Kurzschluss, Kuppler  
Short circuit, socket

SCHUTZKAPPEN ■ PROTECTIVE CAPS



BN 23 90 00

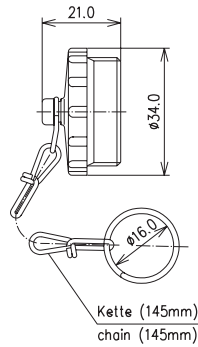

**BN 23 90 00**  
Schutzkappe (Polycarbonat)  
mit Kette für Stecker  
Protective cap (polycarbonate)  
with chain for plugs



BN 23 90 02

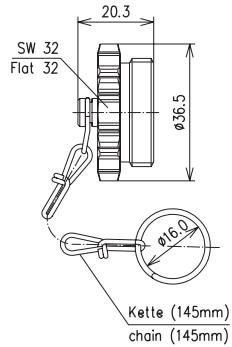

**BN 23 90 02**  
Schutzkappe (Cu-Legierung)  
mit Kette für Stecker  
Protective cap (copper alloy)  
with chain for plugs



BN 23 89 00

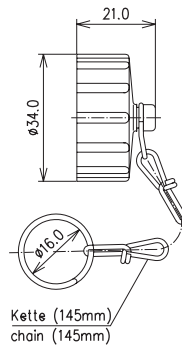

**BN 23 89 00**  
Schutzkappe (Polycarbonat)  
mit Kette für Kuppler  
Protective cap (polycarbonate)  
with chain for sockets



BN 23 89 50

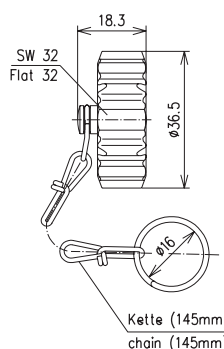

**BN 23 89 50**  
Schutzkappe (Cu-Legierung)  
mit Kette für Kuppler  
Protective cap (copper alloy)  
with chain for sockets

## CABLE ENTRIES

Für Kabel von 3 mm bis 7,5 mm Durchmesser über Dielektrikum liefert SPINNER Kabeleinführungen, die mit verschiedenen Steckerköpfe zu geraden Steckverbindern oder Winkelsteckverbindern kombiniert werden können.

Kabeleinführungen und Steckerköpfe bieten wir getrennt an. Die Steckerköpfe sind unter den jeweiligen Steckverbinder-Serien (z.B. 7-16) zu finden.

Alle Kabeleinführungen haben ein Anschlussgewinde M10 x 0,75 (3 mm lang) und können in jeden, beliebigen Steckverbinderkopf von SPINNER geschraubt werden.

For cables from 3 mm up to 7.5 mm diameter of the dielectric SPINNER offers cable entries that can be combined with various connector heads to make straight or angular connectors.

We offer cable entries and connector heads separately. The connector heads are listed under the respective connector series (e. g. 7-16).

All cable entries have a connection thread M10 x 0.75 (3 mm long) and can be screwed into any SPINNER connector head.



BN 41 94 00

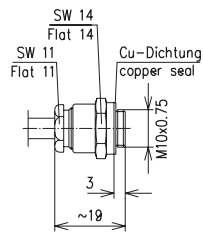

BN 41 95 00

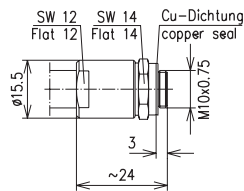

BN 42 01 00 / BN 98 29 00

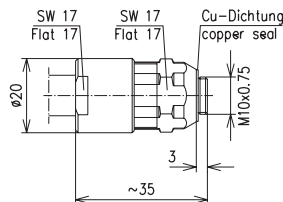

BN 98 29 11

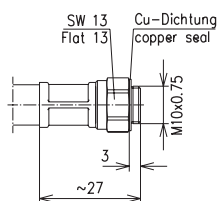

Kabel Typ Cable type	Ausführung Version	Bestell-Nr. Part-No.
RG 55 B/U RG 58 C/U RG 142 B/U RG 223/U RG 400/U	geklemmt clamped	BN 41 94 00
RG 59 B/U	geklemmt clamped	BN 41 95 00
RG 213/U	geklemmt clamped	BN 42 01 00
RG 214/U RG 216/U RG 393/U	geklemmt clamped	BN 98 29 00
RG 214/U RG 393/U	gecrimpt crimped	BN 98 29 11